

RECEIVED  
SOUTHBOROUGH TOWN CLERK

2025 SEP 17 P 2:40  
SS

**PUBLIC HEARING NOTICE  
for SCENIC ROAD TREE REMOVAL  
AND STONEWALL REMOVAL HEARING**

The Southborough Tree Warden and the Southborough Planning Board, under MGL, Chapter 87, Section 3, and MGL Chapter 40, Section 15C, will conduct a consolidated public hearing with the Tree Warden on **Monday, September 29, 2025 at 6:30 PM at the Southborough Town House, McAuliffe Hearing Room, 17 Common St., and via Zoom**, to discuss the removal of two (2) DPW requested trees and removal of approximately 10 ft. of stonewall remnants located on Richards Road. The trees are both Norway Maples and 18" in diameter.

Those who wish to watch or participate remotely may do so by accessing the meeting link at: <https://www.southboroughma.gov/674/Virtual-Meetings>

Each tree is posted. A complete list of the proposed tree removal locations, species, size and pictures can also be found at: <https://www.southboroughma.gov/266>

Christopher Leroy  
Tree Warden Designee

Meme Luttrell  
Planning Board, Chair

Please run this ad on **Sunday, September 21, 2025, and Monday, September 22, 2025.**

Please bill:  
Town of Southborough  
Planning Department  
17 Common St.  
Southborough, MA 01772  
Attn: Colleen Stansfield



RECEIVED  
SOUTHBOROUGH TOWN CLERK  
2025 SEP 17 P 2:40  
SS

**TOWN OF SOUTHBOROUGH**  
**Planning Board**  
**Application for a**  
**Scenic Road Stonewall or Tree Removal**

In accordance with Massachusetts General Laws Chapter 40, §15C permit from the Planning Board of the Southborough Zoning Code.

Name of Applicant(s): William Cundiff

DPW Superintendent

Address of Applicant(s): 147 Cordaville Road, Southborough, MA 01772

Telephone No: 508-485-1210 Cell No: \_\_\_\_\_

Email Address: wcundiff@southboroughma.com

Location of Stonewall/Tree to be Removed Corner of Richards Road & Killian Farm/Moulton

Describe the reasons a Stonewall/Tree should be removed and benefit to the Town

Two trees to be removed to construct an ADA-compliant crosswalk and install a RRFB that is being provided by MassDOT. Also to remove remnant stones adjacent to

Zoning District: Residence B Stonewall - (KG)

Plan Prepared by: VHB

Address: 120 Front Street, Worcester, MA 01608

Telephone No: 508-513-2716 Cell No: 617-817-8542

Email Address: grussell@vhb.com

Date of Plan: 8/8/2025

**Submittal Requirements**

- 10 copies of the plan indicating the Stonewall/Tree to be removed
- An application fee (See Fee Schedule). Should the Planning Board require the plan be reviewed by the Town's consulting engineer, the applicant will be required to pay this cost.

This application is submitted on 8/3/2025

Signature: [Signature] William Cundiff

Title: DPW Superintendent

Any material (in addition to that included with the Application Form) that will be referred to by the Applicant (or the Applicant's representatives) at any public hearing or public meeting must be submitted to the Planning Department at least 7 days prior to such hearing or meeting to ensure adequate and proper review by the Board and accessibility to the public. Any material submitted later than this deadline may, at the Board's discretion, constitute a constructive request by the Applicant for a continuation of the hearing if, in the opinion of the Board, the Board, Town staff, or the public have not had adequate time to appropriately consider such material. **Applicants should note that this additional material includes amended plans, renderings, visual displays, models, etc., that may have been prepared after the Application Form was filed and are expected to be used by the Applicant during a public hearing presentation.**

RECEIVED

SEP 17 2025

Southborough  
Planning Department

Accepted September 21, 2015

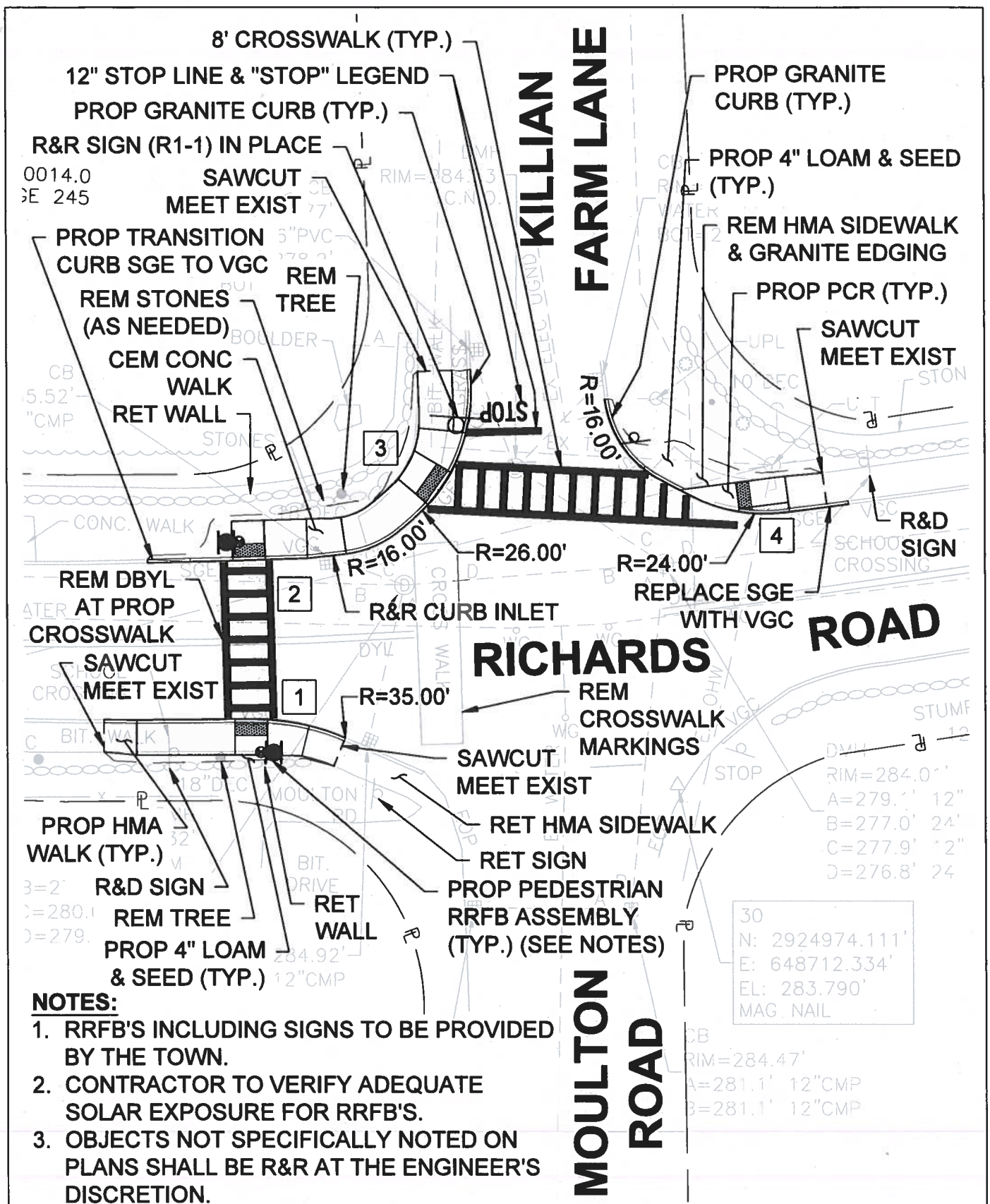





Town of Southborough  
Richards Road at Killian Farm Lane & Moulton Road  
May 23, 2025

Trees TID Number	Address	Species	Type Diameter	Modifications	Tree Warden Evaluation	Arborist Recommendation
1	43 Richards Road	Norway Maple	18"	Tree Removal for construction of a new crosswalk and installation of RRFB	Will not survive Const	N/A
2	1 Moulton Road	Norway Maple	18"	Tree Removal for construction of a new crosswalk and installation of RRFB	Will not survive Const	N/A

Tree ID

Please estimate  
height

Tree 1 35'

Tree 2 30'

*[Signature]*  
9/18/25

Chris Leroy can  
state this N/A.  
Since there is no  
Hazard or Dying Trees  
'Will not survive construction'  
is also relevant

# TOWN OF SOUTHBOROUGH



## PLANNING BOARD

TOWN HOUSE · 17 COMMON STREET · SOUTHBOROUGH, MASSACHUSETTS 01772-1662  
(508) 485-0710, ext 3028 FAX (508) 983-7752 kquinn@southboroughma.com

## SCENIC ROAD PUBLIC SHADE TREE REMOVAL FORM (INTERNAL WORK FLOW FORM)

\* Resident Requesting: William Cundiff - DPW Superintendent  
(Name & Address)

Phone: 508 485 1210

Email: wcundiff@southboroughma.gov

Tree Location: 43 Richards Road

Closest Utility Pole #: 17

☐ Photo(s) Taken visible + clear on Google Street view

Tree Species: NORWAY maple

Tree Diameter: 18"

Resident reason for removal/project description: (attach additional plans or description if needed)

TREE Removal for Construction of a new  
CROSSWALK and installation of RRFB

\* Tree Warden Designee's ~~X~~ Evaluation (public or private tree) & Recommendation (healthy tree or safety concern):

TREE WILL NOT SURVIVE CONSTRUCTION

Arborist's recommendation: (if applicable)

N/A

Tree Warden's Signature: [Signature]

Date of Action: 9/18/25

2024 04.11 PB Public Shade Tree Removal Form (Internal Work Flow Form)

\* NOT a resident

\* NO TREEWARDEN Designee anymore



# TOWN OF SOUTHBOROUGH



## PLANNING BOARD

TOWN HOUSE 17 COMMON STREET SOUTHBOROUGH, MASSACHUSETTS 01772-1662  
(508) 485-0710, ext 3028 FAX (508) 983-7752 kquinn@southboroughma.com

## SCENIC ROAD

### PUBLIC SHADE TREE REMOVAL FORM (INTERNAL WORK FLOW FORM)

\* Resident Requesting: William Cundiff - DPW Superintendent  
(Name & Address)

Phone: 508-485-1210

Email: wcundiff@southboroughma.gov

Tree Location: 1 Moulton Rd

Closest Utility Pole #: 17

☐ Photo(s) Taken visible + clear on Google Street view

Tree Species: NORWAY maple

Tree Diameter: 18"

Resident reason for removal/project description: (attach additional plans or description if needed)

TREE Removal for Construction of a new  
CROSSWALK and installation of RRFB

\* Tree Warden Designee's ~~X~~ Evaluation (public or private tree) & Recommendation (healthy tree or safety concern):

TREE WILL NOT SURVIVE CONSTRUCTION

Arborist's recommendation: (if applicable)

N/A

Tree Warden's Signature: [Signature]

Date of Action: 9/18/25

2024.04.11 PB Public Shade Tree Removal Form (Internal Work Flow Form)

\* Not a resident

\* NO TREEwarden Designee anymore